

PQ CORES

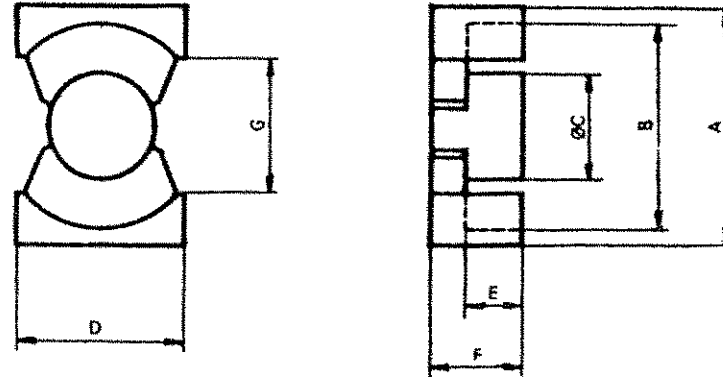

Type		PQ20 × 16	PQ20 × 20	PQ26 × 20	PQ26 × 25	PQ32 × 20	PQ32 × 30	PQ35 × 35	PQ40 × 40
Dimensions (mm)	A	20.5 ± 0.4	20.5 ± 0.4	26.5 ± 0.45	26.5 ± 0.45	32.0 ± 0.5	32.0 ± 0.5	35.0 ± 0.5	40.0 ± 0.4
	B	18.0 ± 0.4	18.0 ± 0.4	22.5 ± 0.45	22.5 ± 0.45	27.5 ± 0.5	27.5 ± 0.5	32.0 ± 0.5	37.0 ± 0.6
	C	9.0 ^{-0.4} ₀	9.0 ^{-0.4} ₀	12.2 ^{-0.4} ₀	12.2 ^{-0.5} ₀	13.7 ^{-0.5} ₀	13.7 ^{-0.5} ₀	14.6 ^{-0.5} ₀	15.2 ^{-0.6} ₀
	D	14.0 ± 0.4	14.0 ± 0.4	19.0 ± 0.45	19.0 ± 0.45	22.0 ± 0.5	22.0 ± 0.5	26.0 ± 0.5	28.0 ± 0.5
	E	5.0 ^{+0.3} ₀	7.0 ^{+0.3} ₀	5.6 ^{+0.3} ₀	7.9 ^{+0.3} ₀	5.6 ^{+0.3} ₀	10.5 ^{+0.3} ₀	12.35 ^{+0.3} ₀	14.6 ^{+0.3} ₀
	F	8.2 ^{-0.2} ₀	10.2 ^{-0.2} ₀	10.2 ^{-0.25} ₀	12.5 ^{-0.25} ₀	10.4 ^{-0.25} ₀	15.3 ^{-0.25} ₀	17.5 ^{-0.25} ₀	20.0 ^{-0.25} ₀
	G	12.0min	12.0min	15.5min	15.5min	19.0min	19.0min	23.5min	27.5min
Core Factor	C ₁ (cm ⁻¹)	6.05	7.38	3.91	4.71	3.26	4.64	4.48	5.08
Effective Length	le (cm)	3.74	4.54	4.63	5.55	5.55	7.46	8.79	10.19
Effective Area	Ae (cm ²)	0.62	0.62	1.19	1.18	1.70	1.16	1.96	2.01
Effective Volume	Ve (cm ³)	2.31	2.79	5.49	6.53	9.42	11.97	17.26	20.45
Approx Weight	W (g)	13	15	31	36	42	55	73	95
A _L Value (nH ± 25%)	R2kBD	3880	3310	6170	5250	7310	5140	4860	4300
Core Loss Pc (W) (25KHz, 200MT, 100°C)	R2kBD	≤0.35	≤0.42	≤0.81	≤0.99	≤1.22	≤1.64	≤2.22	≤2.74